

SERVICE TIPS

Updated: 01/2011

DIFFICULTY LEVEL - 4

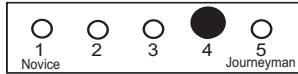

30 to 40 Min

Before working - always follow all instructions and warnings described in the Operator's Manuals for this mower.

NOTICE:

If you are unsure of how to use these instructions please contact us by e-mail: service@ybravo.com or by phone: 1.888.ybravo.1 (1.888.927.2861)

Tools needed:

1 pcs 10mm wrench
1 pcs 13mm wrench

Alternatively (better)

1 pcs 10mm socket
1 pcs 13mm socket



STEP 1

Always remove the ignition cable from the spark plug before performing any service work!



STEP 2

Remove the 13mm nut and the 10mm hex screw for the belt guard as illustrated.



Pull the shift lever towards the "LO" speed setting of the transmission. Lift up on the shift lever at the same time as lifting the cover. The cover slides off towards the right side.



STEP 3

Slide the belt off the transmission pulley. Do not bend the belt guide.

Note:

It is important that the belt guide hold the belt close to the pulley without pushing the belt into the groove of the pulley. If the guide is pushing the belt into the pulley the mower can become difficult to pull back.



STEP 4

Place the rear of mower on a support as illustrated.



STEP 5

Remove the wheels and both wheel brackets. If necessary use the puller 201176-1 to assist the removal of the brackets from the axle.



STEP 6

Remove the three 10mm nuts located at the bottom of the transmission.

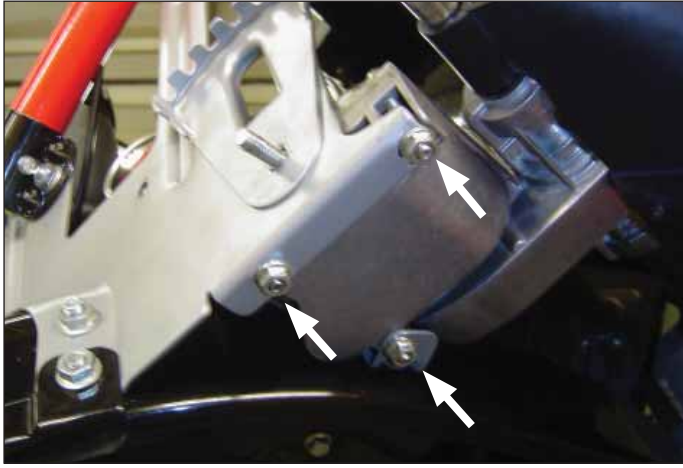

STEP 7

Remove the 6 screws that hold the brackets to the mower deck and the 4 screws at the back plate. The brackets will slide up and pass the wear strips on the deck.

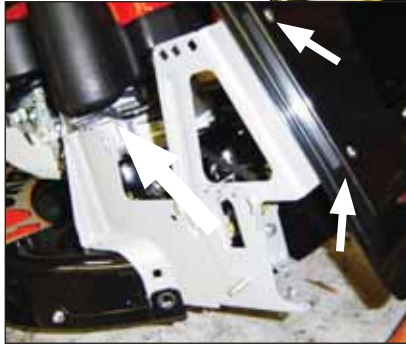
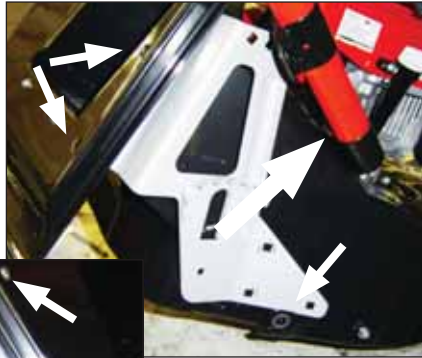

STEP 8

Transfer the nut clips to the new brackets. If needed, squeeze the nut with a pair of pliers to ensure a tight fit to the new bracket.



STEP 9

Slide the new brackets onto the mower. It might require some force to slide the bracket past the wear strip on the right side. Note the angle of the bracket that is needed for installation.



STEP 10

Install all screws and nuts, however DO NOT tighten. It is usually helpful to use a small screwdriver to align the bracket and the nut clips

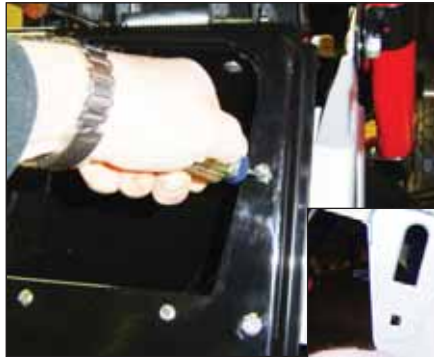

Step 11

Inspect the ball bearing in each wheel bracket for damage before installation. The bearings can easily be replaced by removing the screw from the clamp. The bearing is the same size as used for the front wheels.



Step 12

Assemble the transmission and wheel brackets on the mower - left first (1). DO NOT TIGHTEN any screws.

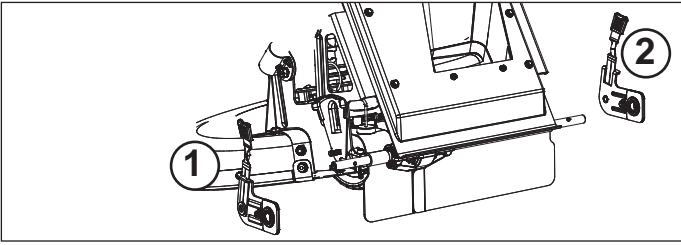

Step 13

Tighten the screws in the following sequence:

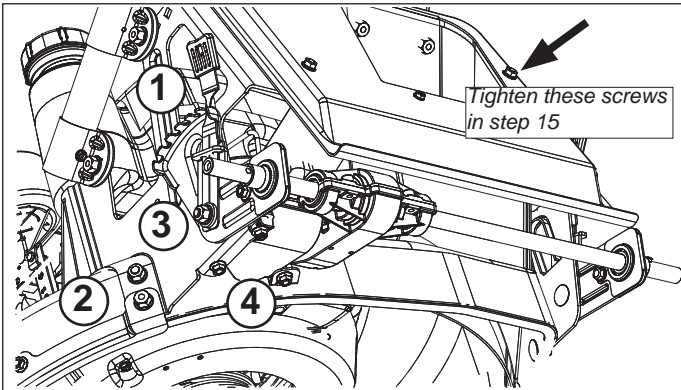

1. Place the height adjustment lever at the same height on the Right and Left side
2. Tighten the three nuts for each bracket assembly on the Right and Left side
3. Tighten the wheel bracket nut on the Right and Left side
4. Tighten the three nuts for the transmission

DO NOT TIGHTEN the screws for the back plate - see step 15

STEP 14

Make sure that the belt is properly in place and the belt guide (5) is properly adjusted. During installation of the transmission it is possible for the belt to come off the engine pulley. Verify the belt guide adjustment by rotating the wheel in reverse with the transmission shifted into the "HI" speed position.

Make sure the return spring (6) for the belt tensioning arm is properly in place.

Note:

Failure of the spring will cause an intermittent problem with pulling back on the mower when it is in HI or LO speed position.

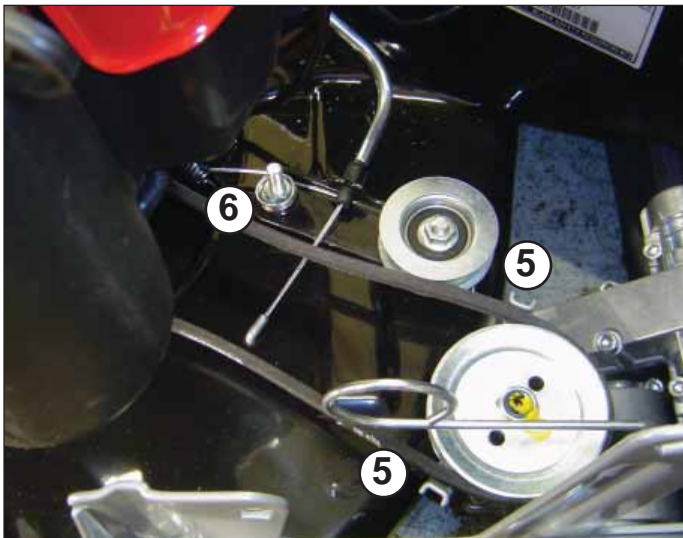

STEP 15 Wheel Alignment

To ensure that all wheels are supporting the mower evenly place the mower on a flat floor. By pulling UP on each front wheel it is easy to establish which wheel has more weight.

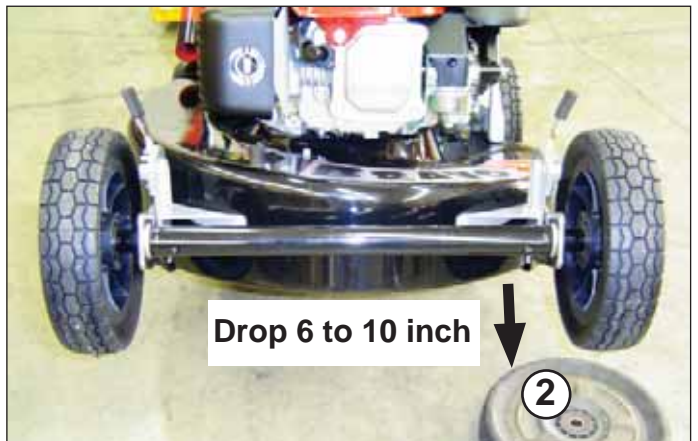

EXAMPLE

1. If one wheel has more traction (weight) than the other (for example left front) - lift the front of the mower approximately 6 to 10 inches above the floor
2. Place a piece of wood or an old wheel under the wheel with the most traction. Drop the mower and let the wheel with the most traction hit the raised surface once
3. Check alignment again
4. When satisfied, tighten the four screws on the back plate

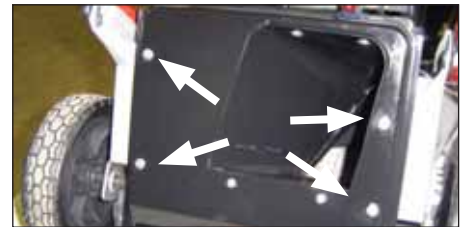

STEP 16

The rear bracket kit also included four handle tube clamps. These clamps are made in spring steel with a high clamping force.

Replace clamps as needed.

