

SERVICE TIPS

DIFFICULTY LEVEL - 2



10 to 15 Min

Before working - always follow all instructions and warnings described in the Operator's Manuals for this mower.

NOTICE:

If you are unsure of how to use these instructions please contact us by e-mail: service@ybravo.com or by phone: 1.888.ybravo.1 (1.888.927.2861)

Tools needed:

- 1 pcs 10mm wrench
- 1 pcs 13mm wrench

Alternatively (better)

- 1 pcs 10mm socket
- 1 pcs 13mm socket



STEP 1

Always remove the ignition cable from the spark plug before performing any service work!



STEP 2

Remove the 13mm nut and the 10mm hex screw for the belt guard as illustrated.

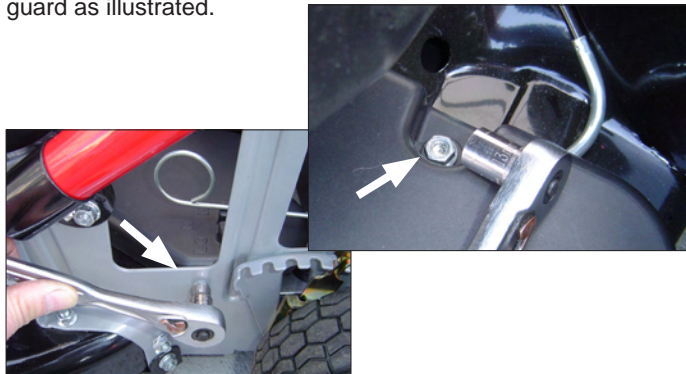

Pull the shift lever towards the "LO" speed setting of the transmission. Lift up on the shift lever at the same time as lifting the cover. The cover slides off towards the right side.

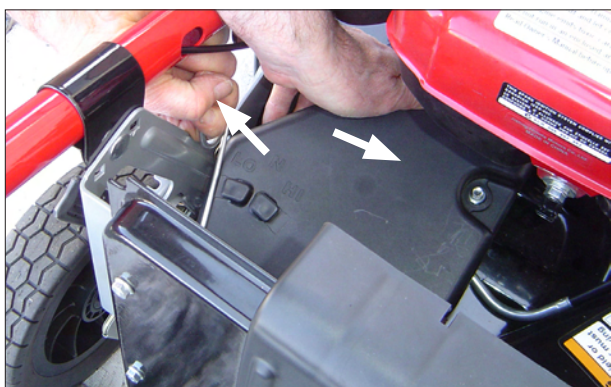

STEP 3

Slide the belt off the transmission pulley. Do not bend the belt guides.

Note:

It is important that the belt guides holds the belt close to the pulley without pushing the belt into the groove of the pulley. If the guides are pushing too much on the belt the mower will be hard to pull back.

A new belt can temporarily create more friction on the pulley and therefore making it more difficult to pull back on the mower. The belt will "break-in" after only a few minutes of operation.

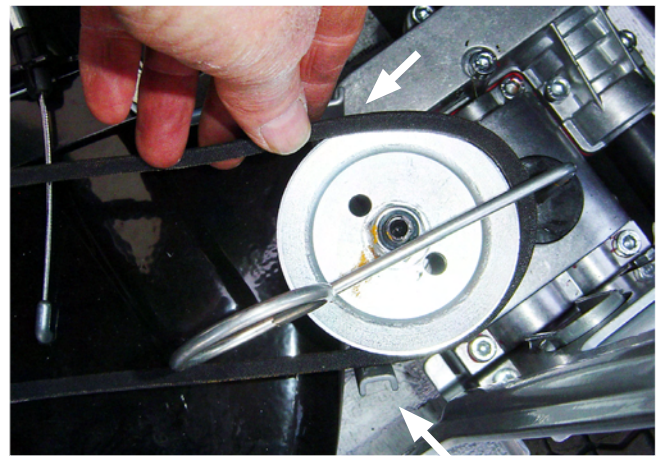

STEP 4

Place the mower on its Right Side.

Pull the belt away from the engine pulley past the belt guides.

Slide the belt over the blade.



STEP 5

Reinstall a new belt and follow the instructions in reverse order.